

Vibrance

Simple & straightforward set of outdoor rated ceiling cylinders & wall lights with the option of single throw or upward & downward throw
Available in multiple sizes and power options to suit various applications



Project - Marriott Executive Apartments
Hyderabad, India

Vibrance - Features

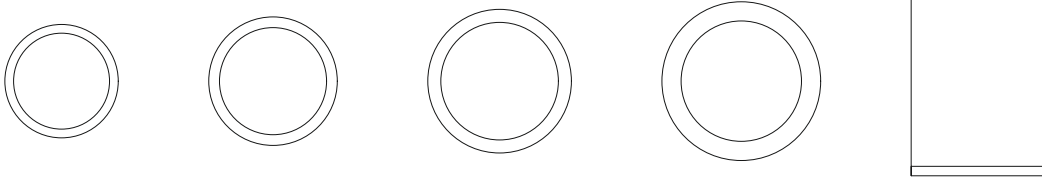

- 4 Round Sizes
- Multiple Optics
- Inbuilt Driver
- Ceiling Mounted

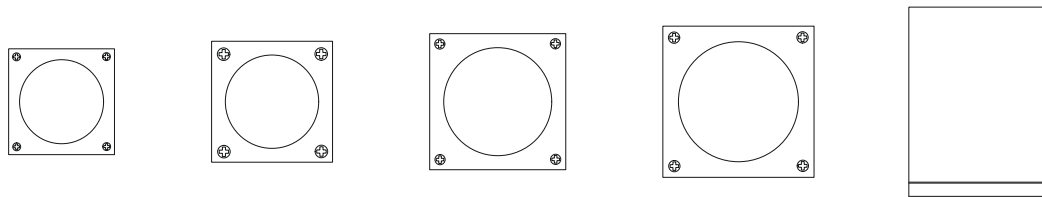

- 4 Square Sizes
- Multiple Optics
- Inbuilt Driver
- Ceiling Mounted

Vibrance Wall - Features



- Downward Throw
- 3 Round & Square Sizes
- Multiple Optics
- Inbuilt Driver
- Wall Mounted

Vibrance Wall Duo - Features



- Up & Downward Throw
- 3 Round & Square Sizes
- Multiple Optics
- Inbuilt Driver
- Wall Mounted

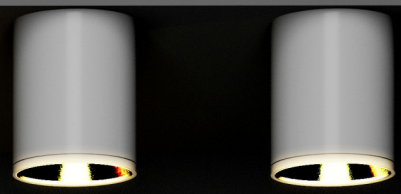
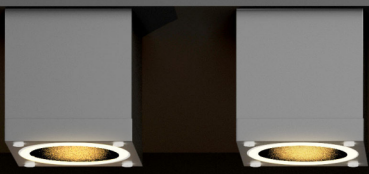

Vibrance Square

- S - 65x65x120mm
- M - 90x90x120mm
- L - 120x120x200mm
- XL - 150x150x200mm

Vibrance Round

- S - Ø65xH100mm
- M - Ø90xH120mm
- L - Ø110xH200mm
- XL - Ø145xH200mm

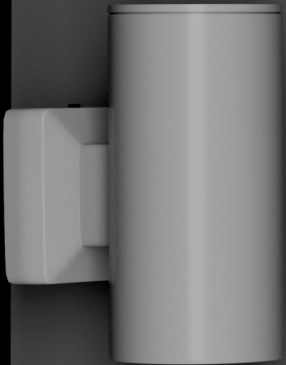

Vibrance Wall Duo Round

- S - Ø65xH160mm
- M - Ø90xH260mm
- L - Ø110xH300mm

Vibrance Wall Duo Square

- S - 65x65x180mm
- M - 90x90x260mm
- L - 120x120x300mm

Vibrance Wall Round

- S - Ø65xH120mm
- M - Ø90xH160mm
- L - Ø110xH240mm

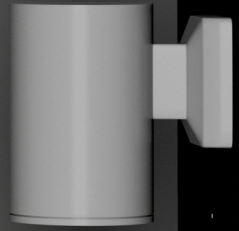

Vibrance Wall Square

- S - 65x65x120mm
- M - 90x90x160mm
- L - 120x120x200mm

Vibrance

LED	Typ CRI	Body Finish	Voltage	IP Rating	Dimming Options	Filter Options
Array 2 Step MacAdam L90-B10 60,000Hrs	95	Matt White Matt Black Matt Grey	AC230V	IP65	Non Dim Triac Analog Dali	Honeycomb

Vibrance R

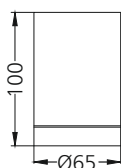
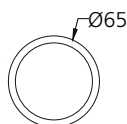

Vibrance RS
#3103

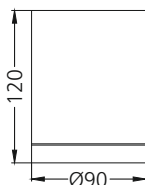
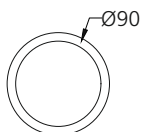

Vibrance RM
#3104

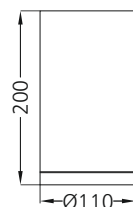
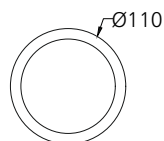

Vibrance RL
#3105

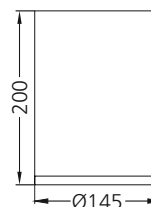
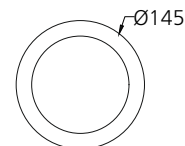

Vibrance RXL
#3106

Power	5W	10W	20W	30W
Lumen / CCT	430lm - 2700K 440lm - 3000K 455lm - 4000K	855lm - 2700K 875lm - 3000K 905lm - 4000K	1720lm - 2700K 1765lm - 3000K 1815lm - 4000K	2595lm - 2700K 2660lm - 3000K 2740lm - 4000K
UGR	<19	<19	<19	<19
Beam Angle	15° 24° 38° 60°	15° 24° 38° 60°	15° 24° 38° 60°	15° 24° 38° 60°
Driver Placement	In-built - AC230V	In-built - AC230V	In-built - AC230V	In-built - AC230V

Vibrance

LED	Typ CRI	Body Finish	Voltage	IP Rating	Dimming Options	Filter Options
Array 2 Step MacAdam L90-B10 60,000Hrs	95	Matt White Matt Black Matt Grey	AC230V	IP65	Non Dim Triac Analog Dali	Honeycomb

Vibrance S

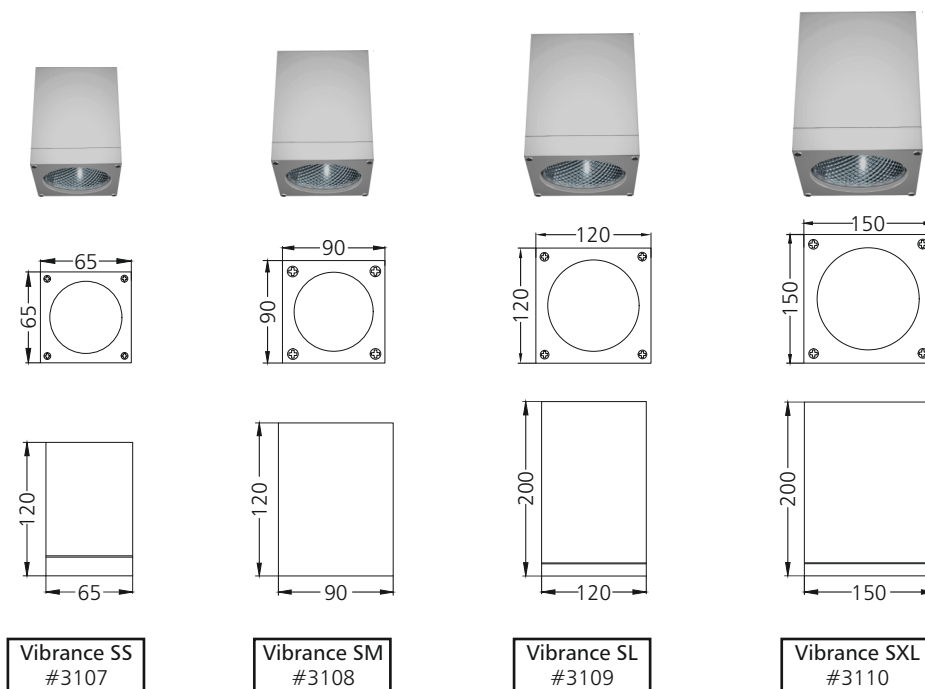

Power	5W	10W	20W	30W
Lumen / CCT	430lm - 2700K 440lm - 3000K 455lm - 4000K	855lm - 2700K 875lm - 3000K 905lm - 4000K	1720lm - 2700K 1765lm - 3000K 1815lm - 4000K	2595lm - 2700K 2660lm - 3000K 2740lm - 4000K
UGR	<19	<19	<19	<19
Beam Angle	15° 24° 38° 60°	15° 24° 38° 60°	15° 24° 38° 60°	15° 24° 38° 60°
Driver Placement	In-built - AC230V	In-built - AC230V	In-built - AC230V	In-built - AC230V

Vibrance Wall

LED	Typ CRI	Body Finish	Voltage	IP Rating	Dimming Options	Filter Options
Array 2 Step MacAdam L90-B10 60,000Hrs	95	Matt White Matt Black Matt Grey	AC230V	IP65	Non Dim Triac Analog Dali	Honeycomb

Vibrance Wall R

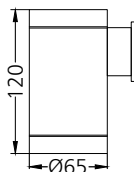
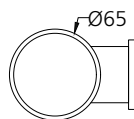

Vibrance Wall RS
#3079

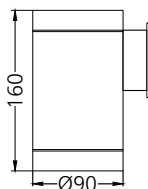
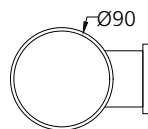

Vibrance Wall RM
#3081

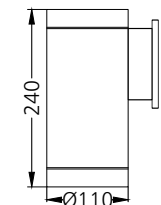
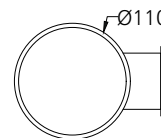

Vibrance Wall RL
#3083

Power	5W	10W	20W
Lumen / CCT	430lm - 2700K 440lm - 3000K 455lm - 4000K	855lm - 2700K 875lm - 3000K 905lm - 4000K	1705lm - 2700K 1750lm - 3000K 1795lm - 4000K
UGR	<19	<19	<19
Beam Angle	15° 24° 38° 60°	15° 24° 38° 60°	15° 24° 38° 60°
Driver Placement	In-built - AC230V	In-built - AC230V	In-built - AC230V

Vibrance Wall

LED	Typ CRI	Body Finish	Voltage	IP Rating	Dimming Options	Filter Options
Array 2 Step MacAdam L90-B10 60,000Hrs	95	Matt White Matt Black Matt Grey	AC230V	IP65	Non Dim Triac Analog Dali	Honeycomb

Vibrance Wall R Duo

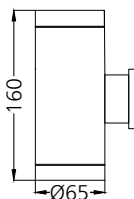
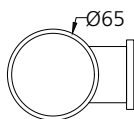

Vibrance Wall RS
#3080

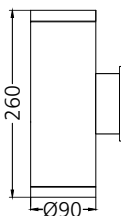
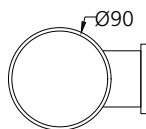

Vibrance Wall RM
#3082

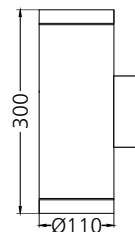
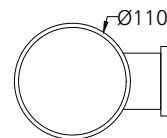

Vibrance Wall RL
#3084

Power	2x5W	2x10W	2x20W
Lumen / CCT	2x430lm - 2700K 2x440lm - 3000K 2x455lm - 4000K	2x855lm - 2700K 2x875lm - 3000K 2x905lm - 4000K	2x1705lm - 2700K 2x1750lm - 3000K 2x1795lm - 4000K
UGR	<19	<19	<19
Beam Angle	15° 24° 38° 60°	15° 24° 38° 60°	15° 24° 38° 60°
Driver Placement	In-built - AC230V	In-built - AC230V	In-built - AC230V

Vibrance Wall

LED	Typ CRI	Body Finish	Voltage	IP Rating	Dimming Options	Filter Options
Array 2 Step MacAdam L90-B10 60,000Hrs	95	Matt White Matt Black Matt Grey	AC230V	IP65	Non Dim Triac Analog Dali	Honeycomb

Vibrance Wall S

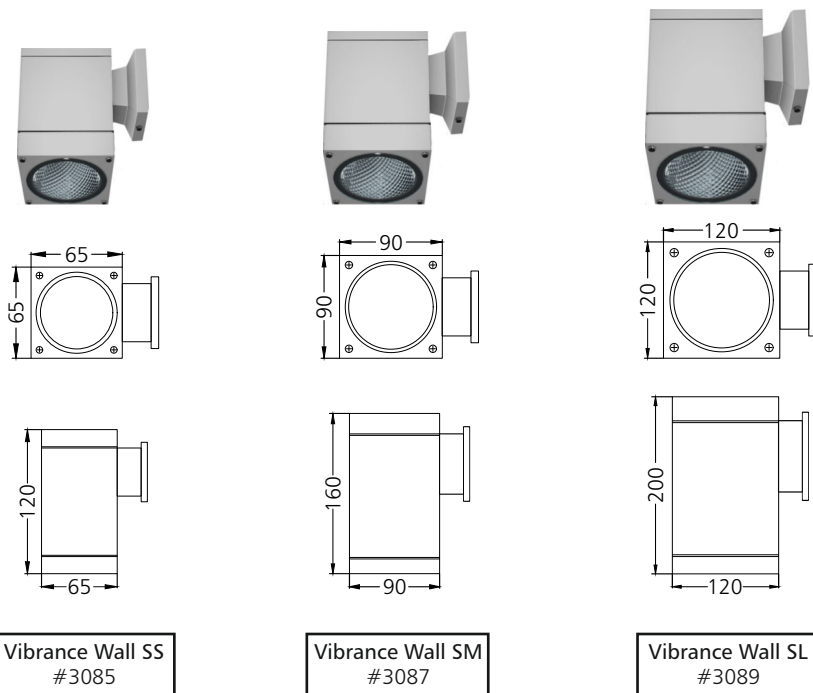

Power	5W	10W	20W
Lumen / CCT	430lm - 2700K 440lm - 3000K 455lm - 4000K	855lm - 2700K 875lm - 3000K 905lm - 4000K	1705lm - 2700K 1750lm - 3000K 1795lm - 4000K
UGR	<19	<19	<19
Beam Angle	15° 24° 38° 60°	15° 24° 38° 60°	15° 24° 38° 60°
Driver Placement	In-built - AC230V	In-built - AC230V	In-built - AC230V

Vibrance Wall

LED	Typ CRI	Body Finish	Voltage	IP Rating	Dimming Options	Filter Options
Array 2 Step MacAdam L90-B10 60,000Hrs	95	Matt White Matt Black Matt Grey	AC230V	IP65	Non Dim Triac Analog Dali	Honeycomb

Vibrance Wall S Duo

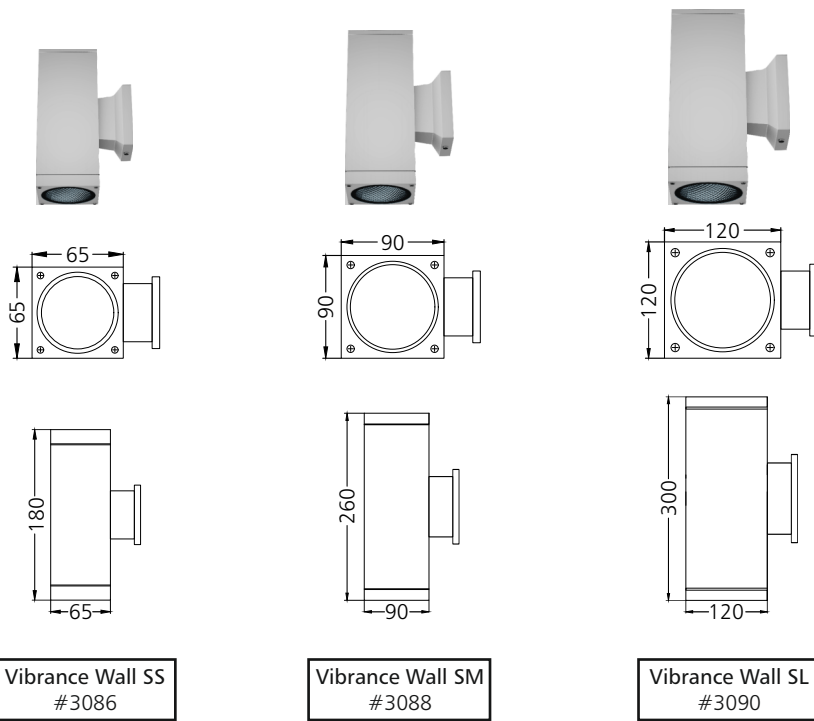

Power	2x5W	2x10W	2x20W
Lumen / CCT	2x430lm - 2700K 2x440lm - 3000K 2x455lm - 4000K	2x855lm - 2700K 2x875lm - 3000K 2x905lm - 4000K	2x1705lm - 2700K 2x1750lm - 3000K 2x1795lm - 4000K
UGR	<19	<19	<19
Beam Angle	15° 24° 38° 60°	15° 24° 38° 60°	15° 24° 38° 60°
Driver Placement	In-built - AC230V	In-built - AC230V	In-built - AC230V